

BINQ TILT & TURN WINDOW
140mm INTERNAL REVEAL
SECTION DETAIL

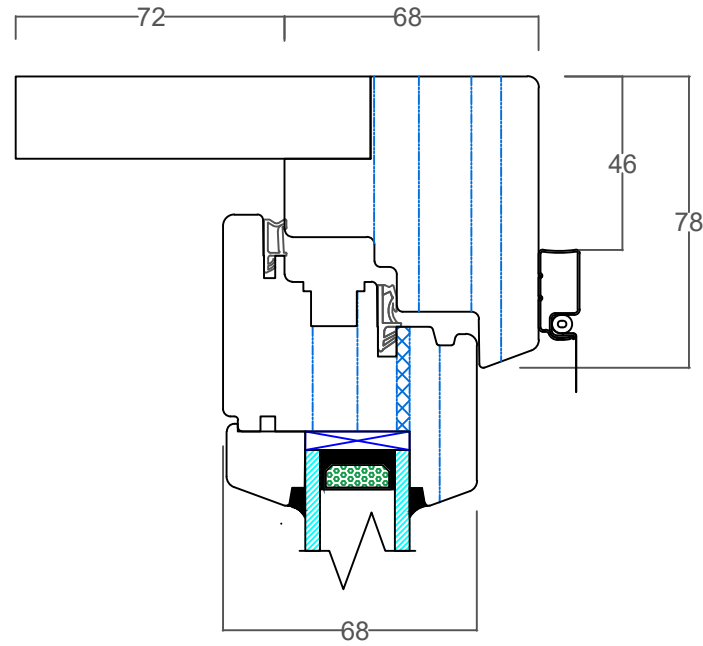

Inside

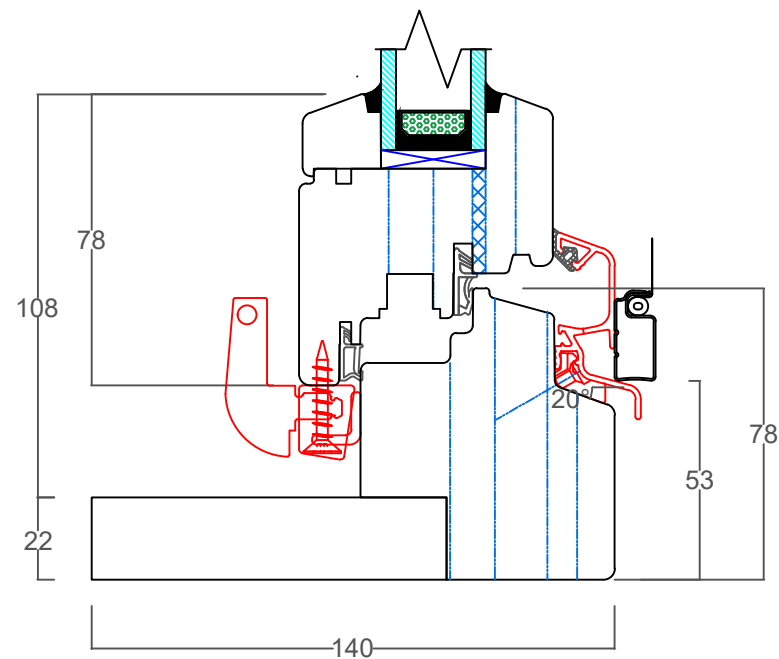

BINQ TILT & TURN WINDOW
140mm INTERNAL REVEAL
PLAN DETAIL

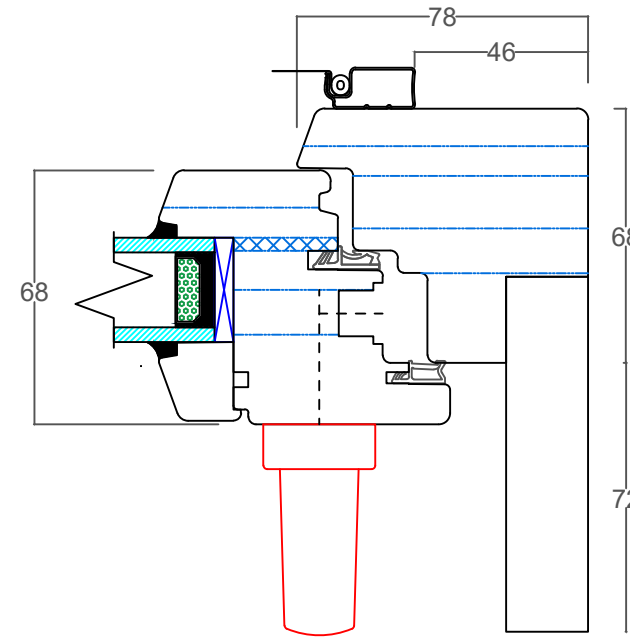
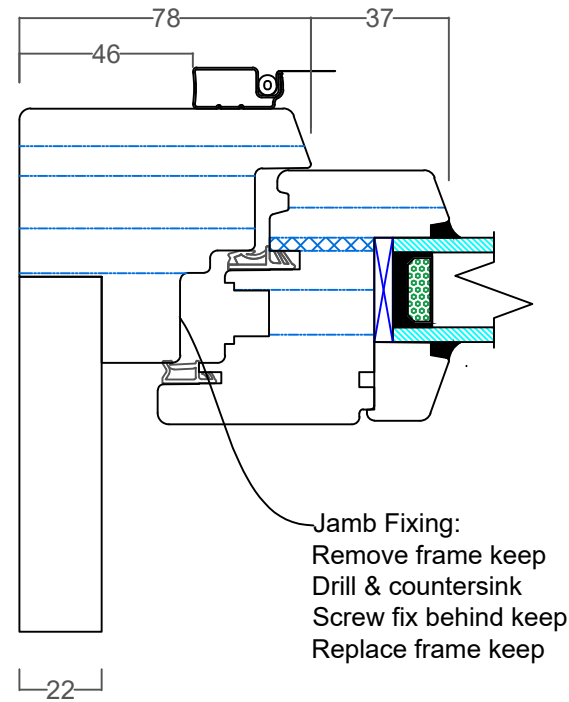

Inside

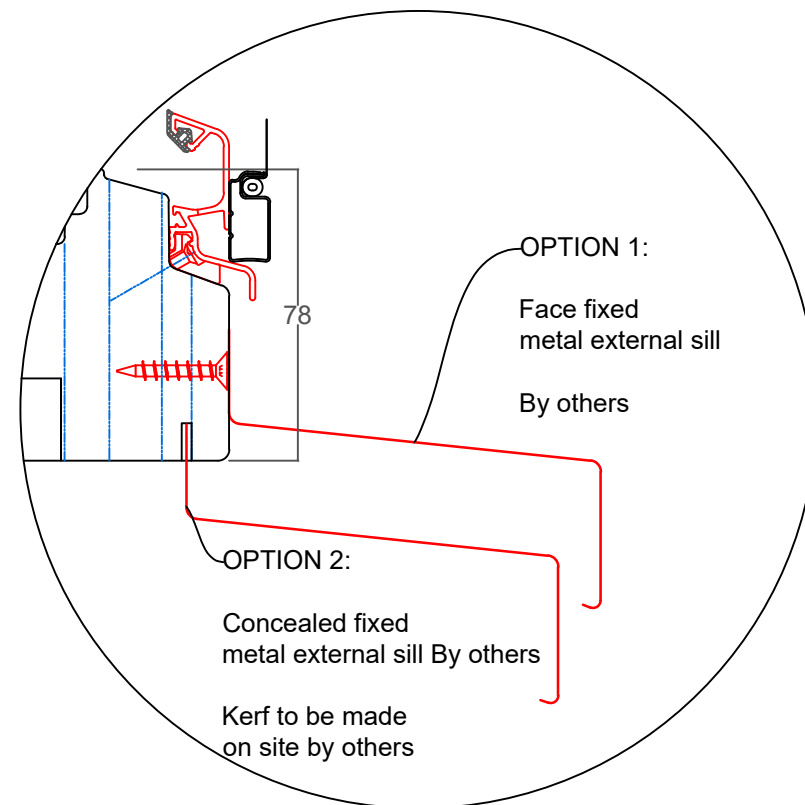

General Notes:

- The information provided here are guidelines only. Always adhere to Australian standards / BCA
- The installation and correct operation of these units in the installed situation is the responsibility of the installer. This includes but not limited to the correct flashing of doors and windows.
- Screw fixings must be used, DO NOT use nails
- The installed units must be plumb, square and level to a laser level. DO NOT use a conventional spirit level
- Check for smooth operation
- Check for even an even gap between sash and jamb
- Operate sash strictly per operating instructions provided
- Sash hardware is adjustable
- Adjust sash per instructions provided if required
- Check all gaskets are seated correctly
- **Decouple and couple sash strictly per instructions provided. Incorrect coupling may result in serious injury to operator**

| Tilt Turn Window | | PROJECT | | www.binq.com.au | REV A |
|--------------------------------|--|-------------|--|-------------------|----------------|
| PART NO. VARIOUS | | PROJECT | | | |
| DRAWN BY/DATE AG 22/03/2019 | | REFERENCE | | SCALE @ A3 DNS | SHEET 1 / 1 |
| MATERIAL VARIES | | REFERENCE | | | |
| FINISH/TREATMENT | | WEIGHT 1 | THIS DRAWING IS THE PROPERTY OF BINQ. Information contained herein is confidential and is not to be used or disclosed to third parties without the written consent of binq | | |